

HALL 6.0

Ground floor



3,799 sqm - 950 seats

TECHNICAL SHEET

HALL 6.0

Ground floor

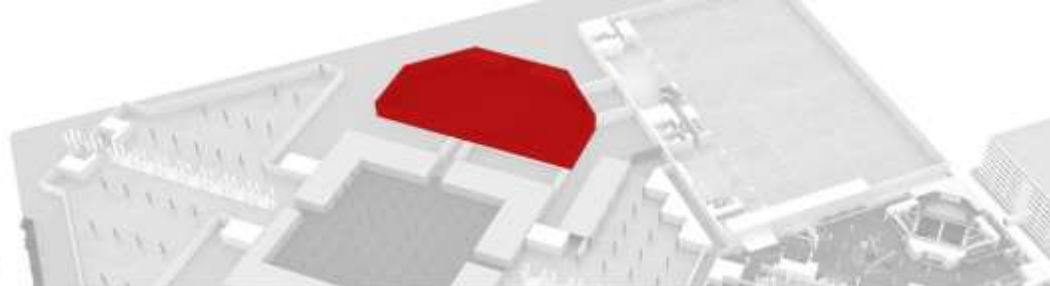

INFORMATION

Gross exhibit space sqm	Hall type	Flooring	Ceiling
3,799	One-storey, single-span construction	Quartz concrete	Reticular steel beams

Floor load capacity kg/sqm	Hanging fixtures	Hight* m	Goods loading/unloading dimensions m	Toilette
1,000	Not permitted	Max 12 Min 6	6,80 x 5,00	4 for women 4 for men 2 for disabled

- Height of the fittings to be respected is defined by the Technical Rules & Regulations

MAIN FEATURES

Hall 6 is a one-storey, open space whose high ceiling echoes post-industrial design with white tubes contrasting the dark floor. Access to the hall is via both the East and West entrances. There is a customizable foyer and a permanent café. It is the ideal location both for events with over 500 guests, and exhibitions and shows.

FEATURES OF ELECTRIC PLANT

- Electrical outlet: 32A 5-pole (3F+N-T)
- Power: 15kw three phase socket
- Tension: 380 v / 220 v

The electrical outlets in the exhibit areas are in floor power outlets. Requests for higher power supplies must be checked and approved by IEG

MAXIMUM CROWD CAPACITY

- Maximum crowd capacity for exhibition: 950 ppl
- Total evacuation capacity: 1500 ppl
- Total number of emergency exits: 30

DEVELOPMENTS ON REQUEST

- Alternative outfitting projects subject to feasibility studies.

HALL 6.0

Ground floor

